

EN

**DANGER**



**CARBON MONOXIDE HAZARD**

- This stove can produce carbon monoxide, which has no odor.
- Using it in an enclosed space can kill you.
- Never use this stove in an enclosed space such as a camper, tent, car, or home.

**FOR YOUR SAFETY  
If you smell gas**

1. Do not attempt to light stove.
2. Extinguish any open flame.
3. Disconnect from fuel canister.

**FOR YOUR SAFETY**

Do not store or use gasoline or other liquids with flammable vapors in the vicinity of this or any other stove.

Specifications  
OUTPUT: 2800kcal/h 3260W 11000BTU  
Duration: Burns approx. 1.5 hours with 250g canister.  
Weight: 73g (2.6 oz.)  
Dimensions when in use: 9.6 x 9.4 x 8.6cm (3.8 x 3.7 x 3.4inch)  
Dimensions when stowed: 5.2 x 5.2 x 8.1cm (2.0 x 2.0 x 3.2inch)

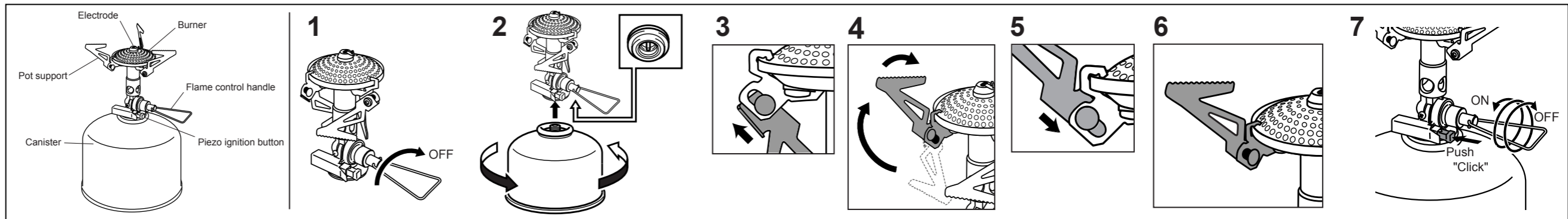

**Instruction Manual**

Be sure to read this manual before using the OD-1R. Keep this manual for future reference, and review its contents to regularly maintain awareness of procedures and warnings. Failure to follow the warnings described in this manual may result in fire, property damage, injury, or death.

**Cautions and Warnings**

1. Never use the OD-1R indoors or in any area with poor ventilation (i.e., in a tent, vehicle, camper, or any other enclosed space). This stove is for outdoor use only.
2. Keep the stove away from the reach of children.
3. Do not use the OD-1R in any way or for any purpose other than described in this manual.
4. Never use the stove near any kind of flammable materials. Keep all such materials at least 1.2m/4ft away from the sides of the stove and at least 1.5m/5ft away from the top while the stove is in use.
5. Never use the OD-1R on any surface that is not flat and firm. Also, do not move, shake, or tilt the stove while it is burning.
6. Never leave the burning or hot stove unattended.
7. Never cover the stove and/or canister with a windscreen, rock or similar item which may cause "over heating". Additionally, do not use the stove near another stove in use, an open fire, or any other heat source. If the stove overheats, it could damage the product and endanger your safety.
8. Changes in pressure at high altitudes may cause difficulty with the Piezo ignition system. Always carry matches or a lighter as a backup.
9. Never use cooking pots that are larger than 180mm/7.1in in diameter. Total weight placed upon the stove should not exceed 2.5kg/5.5lbs, including food and/or liquid. Use only one stove for each pot, and do not allow any vessel to boil dry.
10. When changing canister, make sure the stove is not lit and stay clear of other people and open fires. Avoid dangerous fuel leaks by making sure the canister and stove are threaded correctly. Detach the canister after use, and store canister separately.
11. Do not attempt any maintenance, modification, disassembly, or repair other than what is contained in this manual. If you have any questions, please contact your retailer or SOTO.

Caution: Never touch the stove body when using the OD-1R. The unit will become extremely HOT. After time, parts of the stove may become discolored. This discoloration is natural and does not affect the stove's performance.

**Mounting the Stove**

1. Turn the flame control handle clockwise to OFF position to completely shut off the gas feed. (figure 1)
2. Take the plastic cap off the canister and carefully screw the threaded section on the bottom of the stove assembly into the threaded part of the canister. Tighten slightly firm but do not over-tighten. (figure 2) Over tightening can damage the stove or canister valve which may cause fuel to leak.
3. Slide the pot support at an angle upward until it stops. (figure 3) Then turn it over. (figure 4)
4. Slide the pot support at an angle downward. (figure 5) Confirm that all 3 pot supports are firmly in place before use. (figure 6)

Always check for leaks after installing the fuel canister. Do not light the stove if a leak is detected.

**Using the Stove**

1. Carefully open the valve by turning the control handle counterclockwise (about 1-1.5 turns) until you hear the sound of fuel escaping. Then press the Piezo ignition button quickly to light the stove. (figure 7)
2. If the stove does not immediately ignite, close the valve by turning the control handle fully clockwise. Wait a few seconds and repeat the first step.
3. Once the OD-1R is lit, regulate the intensity of the flame with the control handle. The stove should produce a steady, blue flame.
4. When finished cooking, turn the control handle fully clockwise to shut off the stove.

Parts of the OD-1R will become very hot during use. Use caution when handling the stove, and always let it cool completely before removing it from the canister and packing it.

Do not be concerned if the OD-1R makes a high-pitched whistling sound when in use. This is not a defect in the stove. Atmospheric pressure, air temperature, humidity, etc. cause this to occur from time-to-time.

**After Using the Stove**

1. Make sure the OD-1R has cooled off before attempting to remove it from the fuel canister.
2. Slide the pot support at an angle upward then turn down under the burner head.
3. Unscrew the stove from the canister.
4. Place the stove in the included case for storage.

**Cleaning and Maintenance**

Make a habit of keeping your stove clean. However, never touch the igniter tip. Doing so may clog the igniter and make the stove difficult to use. The stove's o-ring should be replaced when wear, cracking, or leakage occurs. A damaged or leaking stove must be repaired before use. Please contact your retailer or SOTO if you have any maintenance or repair-related questions.

**Additional instructions and information**

**Regarding the flame control knob adjustment**

Unlike many of the stoves on the market, the OD-1R requires the flame control knob to be turned more than other stoves.  
※ The following diagrams show the difference in the valve system between the OD-1R and other stoves on the market. Most stoves have a valve system that releases the gas with a slight turn of the flame control knob; the OD-1R requires about 1-1.5 turns of the flame control knob to release the gas.

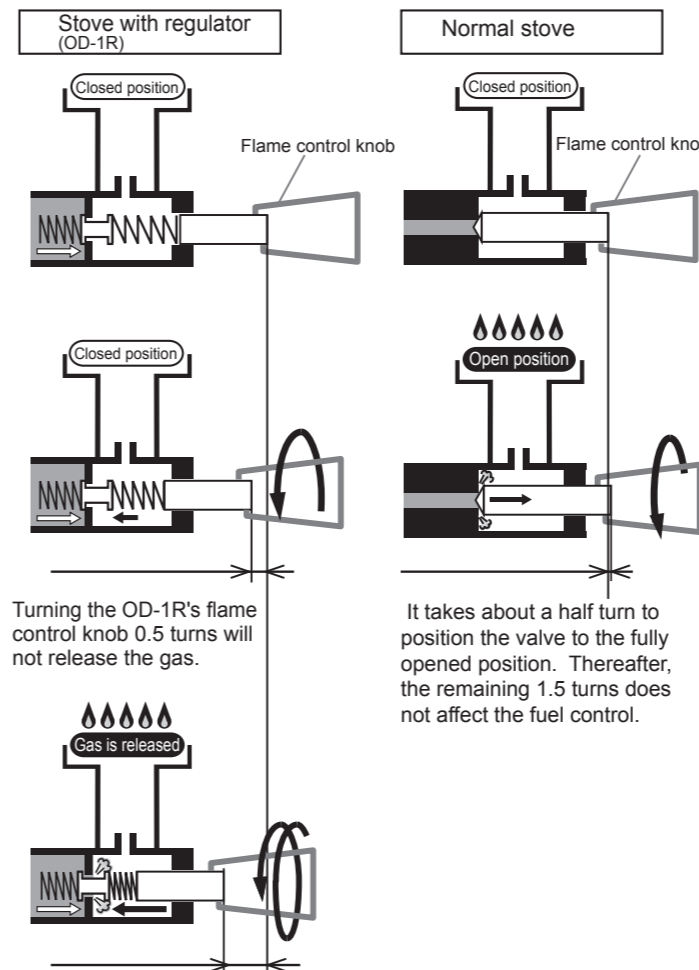

The flame control knob must be turned at least 1-1.5 turns in order to release the gas.

After the flame control knob is turned about 1-1.5 turns, the gas will be released from the valve system. (When the flame control knob is turned all the way, the valve system is at the fully opened position.)

**Igniting the OD-1R at higher elevations**

The atmospheric pressure above 10000 ft, elevations affects ignition of the OD-1R. If there is a wind, it will further affect ignition of the stove. Follow the instructions below under such conditions:

1. Ignite the stove at a location where the wind does not affect the igniting of the stove.
2. Release a small amount of gas, then ignite the stove.

※ Higher atmospheric pressure and rain may adversely affect the stove's ability to ignite, or it may cause the ignition system to break. Always bring an emergency lighting system (i.e., matches or a flint lighter).

**Sound by disassembling the fuel canister**

When the fuel canister is disassembled from the stove, a large pop sound may occur. This is due to the small amount of gas trapped between the two gaskets that are designed to prevent gas leaks. When the fuel canister is removed from the stove, a small amount of gas is released which makes this sound.



Fuel canister installation part

**Fine adjustment for the output**

The OD-1R excels in controlling fuel output. Unlike other stoves on the market, the OD-1R's fuel output can be precisely adjusted due to the regulator system. When the flame control knob stops, the valve system is fully opened. Other stoves on the market offer a small range for fuel adjustment; as a result, it is difficult to precisely adjust the fuel output. Additionally, valves on these stoves completely open before the fuel control knob is in the fully opened position. Therefore, it is difficult to detect when-or at what position-the flame control knob opens the valve fully on other stoves.