

SOTO
Sparked by nature
MICRO REGULATOR STOVE
WindMaster
OD-1RX

Patent Pending

EN

Shin Fuji Burner CO., LTD.

1-1-3 Miyukihama, Mito-cho, Toyokawa-city,
Aichi-pref, 441-0314 Japan
Phone: +81 533 75 5000 FAX: +81 533 75 5033

www.sotooutdoors.com

SOTO USA, INC
Oregon USA
info@sotooutdoors.com
Phone: 503-314-5119

USE OUTDOORS ONLY



DANGER

ONLY USE IN WELL-VENTILATED AREAS.



CARBON MONOXIDE HAZARD
THIS APPLIANCE CAN PRODUCE CARBON MONOXIDE WHICH HAS NO ODOUR. USING IT IN AN ENCLOSED SPACE (FOR EXAMPLE, CARAVAN, TENT, CAR, MOBILE HOME) MAY CAUSE DEATH.

FOR YOUR SAFETY If you smell gas

1. Do not attempt to light stove.
2. Extinguish any open flame.
3. Disconnect from fuel canister.

FOR YOUR SAFETY

Do not store or use gasoline or other liquids with flammable vapors in the vicinity of this or any other stove.

Specifications:

Weight: 2.3 oz or 67g with the pot support

Size:

when in use: 9.0 x 11.7 x 9.7 cm (3.5 x 4.6 x 3.9 inch)

when stowed (Stove body only):

4.7 x 9.0 x 8.8 cm (1.9 x 3.5 x 3.5 inch)

(Pot support only):

9.4 x 1.0 x 3.3 cm (3.7 x 0.4 x 1.4 inch)

Output: 2,800 kcal/h or 3,260 W or 11,000 BTU

Burn time: 1.5 hours with a 250g (8 oz) canister

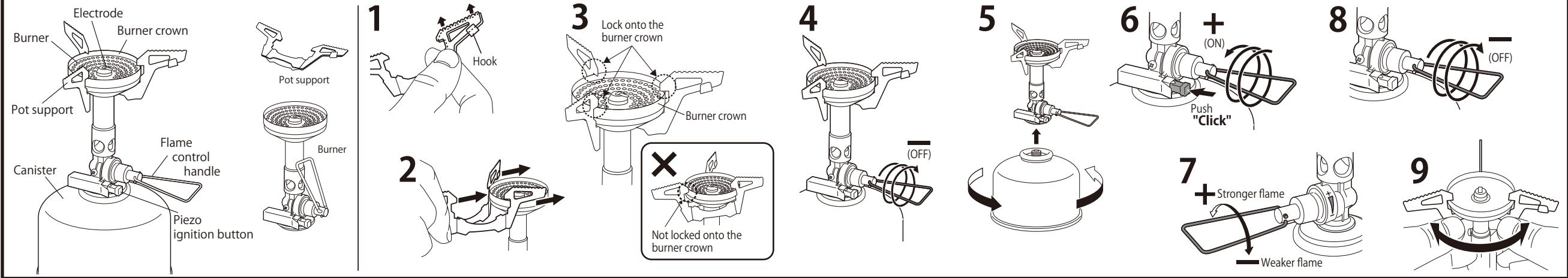

Instruction Manual

Be sure to read this manual before using the stove. Keep this manual for future reference, and review its contents regularly to maintain awareness of procedures and warnings. Failure to follow the warnings described in this manual may result in fire, property damage, injury, or death.

Cautions and Warnings

- Keep the stove away from the reach of children.
- CAUTION: Accessible parts may be very hot.
- CAUTION: This appliance shall only be used in an above ground open air situation with natural ventilation, without stagnant areas, where gas leakage and products of combustion are rapidly dispersed by wind and natural convection.
- Never use the stove near any kind of flammable materials. Keep all such materials at least 1.2m/4ft away from the sides of the stove and at least 1.5m/5ft away from the top while the stove is in use.
- Be sure to remove appliance from carrier, pouch, or any other packing material.
- Do not use this appliance where dangerous goods are stored that could potentially ignite.
- When in use, be sure that there is enough oxygen supply and do not cover any of the combustion air openings located on the post of the stove body.
- Do not use the appliance in any way or for any purpose other than described in this manual.
- Prior to use of appliance, be sure to test igniter by pressing the Piezo button. If sparks are not observed, contact your local dealer or contact SOTO for repair. Confirm that pot supports are secured in place prior to use by applying pressure to avoid potential bodily harm.
- If abnormal sound/flame is heard or observed, stop using unit immediately and contact your local dealer or SOTO for service.
- Do not use this appliance if it is leaking, damaged or does not operate properly.
- In the event that a leak (smell of gas) is detected, immediately turn the appliance off if in use. Detach the fuel canister from the appliance and check if the leak or smell continues.
- If there is a leak from this appliance (smell of gas) and the gas flow cannot be stopped, move the appliance to a well-ventilated location away from any ignition source. Check for leaks using soapy water. Do not try to detect leaks using a flame.
- This appliance is to be operated on a horizontal surface.
- Never leave a burning or hot stove unattended.
- Never cover the stove and/or canister with a windscreen, rock or similar item which may cause "overheating". Additionally, do not use the stove near another stove in use, an open fire, or any other heat source. If the stove overheats, it could damage the product and endanger your safety.
- Changes in pressure at high altitudes may cause difficulty with the Piezo ignition system. Always carry matches or a lighter as a backup.
- Use only one stove for each pot, and do not allow any vessel to boil dry.
- Gas canister shall be changed in a well-ventilated location, preferably outside, away from other people and any sources of ignition, such as naked flames, pilot flames, electric heaters/equipment.
- Avoid dangerous fuel leaks by making sure the canister and stove are threaded correctly. Detach the canister after use, and store canister separately.
- Do not attempt any maintenance, modification, disassembly, or repair other than what is contained in this manual. If you have any questions, please contact your retailer or SOTO.
- Service and any necessary replacement parts may be obtained by contacting www.sotooutdoors.com.
- How to check if the gas canister is empty: Install appliance onto fuel canister. Open valve to ignite. If no gas flows, the fuel canister is empty. Remove fuel canister from appliance. Gently shake to check for any residual fuel remaining inside.
- This appliance must only be serviced by an authorized person.
- When outdoors, store fuel canisters in a well-ventilated area out of the reach of children.
- After time, parts of the stove may become discolored. This discoloration is natural and does not affect the stove's performance.

Cautions regarding the replaceable pot support

- Always place the pot support on the burner head when in use. Never use the stove without first setting up the pot support.
- The stove must be used with the designated pot support. Always set up the pot support according to the instructions.
- Confirm that the stove is completely cooled off when setting up or removing the pot support.
- Never apply excess force to the pot support. Failure to follow these instructions may cause the pot support to bend or deform.
- Never use any cookware that has a diameter larger than that shown in the illustration. Failure to follow this instruction may cause the cookware to fall from or deform the pot support.

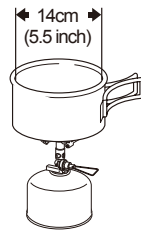

Installing the small pot support

1. Slide one side of the pot support from the hook to release and open it (**figure 1**). The pot support will spring open when one side of the pot support plate is released from the hook.
2. Slide the pot support into burner head (**figure 2**).
3. Position the pot support until it locks onto the burner crown. Confirm that the pot support is firmly in place and secured (**figure 3**).

Cautions:

- Confirm each of the pot supports are located at a 120 degree angle from each other.
- Never use the pot support when it is deformed. Failure to follow this instruction may cause the cookware to fall. Be careful to check for any deformity on the pot support before and after each use.

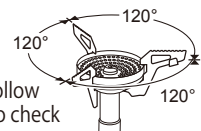

Mounting the Stove

Cautions: Check that O-rings between the appliance and the gas container are in place and in good condition before connecting the gas container. Do not use this appliance if it has damaged or worn O-rings.

1. Turn the flame control handle clockwise to the OFF position to completely shut off the gas feed (**figure 4**).
2. Carefully screw the threaded section on the bottom of the stove assembly into the threaded part of the canister (**figure 5**). Tighten slightly firm but do not over-tighten.

Cautions:

- Over tightening can damage the stove or canister valve which may cause fuel to leak.
- Always check for leaks after installing the fuel canister. Do not light the stove if a leak is detected.

Using the Stove

1. Carefully open the valve by turning the control handle counterclockwise (about 1-1.5 turns) until you hear the sound of fuel escaping. Then press the Piezo ignition button quickly to light the stove (**figure 6**).
2. If the stove does not immediately ignite, close the valve by turning the control handle fully clockwise. Wait a few seconds and repeat the first step.
3. Once the appliance is lit, regulate the intensity of the flame with the control handle. Turn counterclockwise toward + for stronger flame. Turn clockwise toward - for weaker flame (**figure 7**). The stove should produce a steady, blue flame.
4. When finished cooking, turn the control handle fully clockwise to shut off the stove (**figure 8**).

WARNING: Do not move the appliance during operation.

Caution: Do not attempt to touch the appliance when hot. Wait until it is completely cooled off before touching.

Do not be concerned if the stove makes a high-pitched whistling sound when in use. This is not a defect in the stove. Atmospheric pressure, air temperature, humidity, etc. cause this to occur from time-to-time.

After Using the Stove

1. Make sure the stove has cooled off before attempting to remove it from the fuel canister.
2. Open the pot support gently, then remove the pot support from the burner head (**figure 9**).
3. Unscrew the stove from the canister.
4. Place the stove and pot support in the included case for storage.

Cleaning and Maintenance

- Make a habit of keeping your stove clean. However, never touch the igniter tip. Doing so may clog the igniter and make the stove difficult to use.
- The product should be maintained and serviced regularly. The O-rings should be replaced every 3 years. The stove's o-ring should be replaced when wear, cracking, or leakage occurs. A damaged or leaking stove must be repaired before use. Please contact your retailer or SOTO if you have any maintenance or repair-related questions.
- Carefully remove O-rings at the base of the unit with a small flathead screwdriver and/or with fingers (as shown in illustration). After gently removing the O-rings, use a soft cloth to remove any dust or debris that may have accumulated. Use fingers and a flathead screwdriver to install the new replacement O-rings.

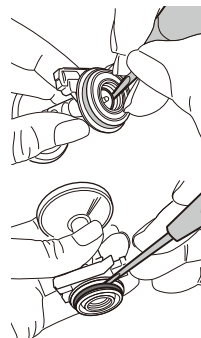

Additional instructions and information

Regarding the flame control knob adjustment

The following diagrams show the difference in the valve system between the OD-1RX and other stoves on the market. Most stoves have a valve system that releases the gas with a slight turn of the flame control knob; the OD-1RX requires about 1-1.5 turns of the flame control knob to release the gas.

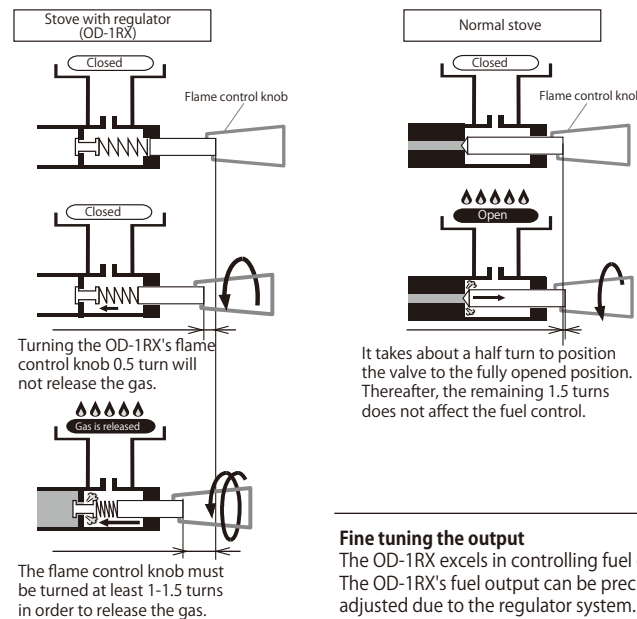

Igniting the OD-1RX at higher elevations

The atmospheric pressure above 10000 ft. elevation affects ignition of the OD-1RX. If there is a wind, it will further affect ignition of the stove. Follow the instructions below under such conditions:

1. Ignite the stove at a location where the wind does not affect the igniting of the stove.
2. Release a small amount of gas, then ignite the stove.

※ Higher atmospheric pressure and rain may adversely affect the stove's ability to ignite, or it may cause the ignition system to break. Always bring an emergency lighting system (i.e., matches or a flint lighter).

Sound when disassembling the fuel canister

When the fuel canister is disassembled from the stove, a large pop sound may occur. This is due to the small amount of gas trapped between the two gaskets that are designed to prevent gas leaks. When the fuel canister is removed from the stove, a small amount of gas is released which makes this sound.



Optional: (sold separately)

4-prong pot support
for WindMaster / OD-1RX

4Flex / OD-1RX4



See more about **4Flex**
→ www.sotooutdoors.com